

A-28-5-2

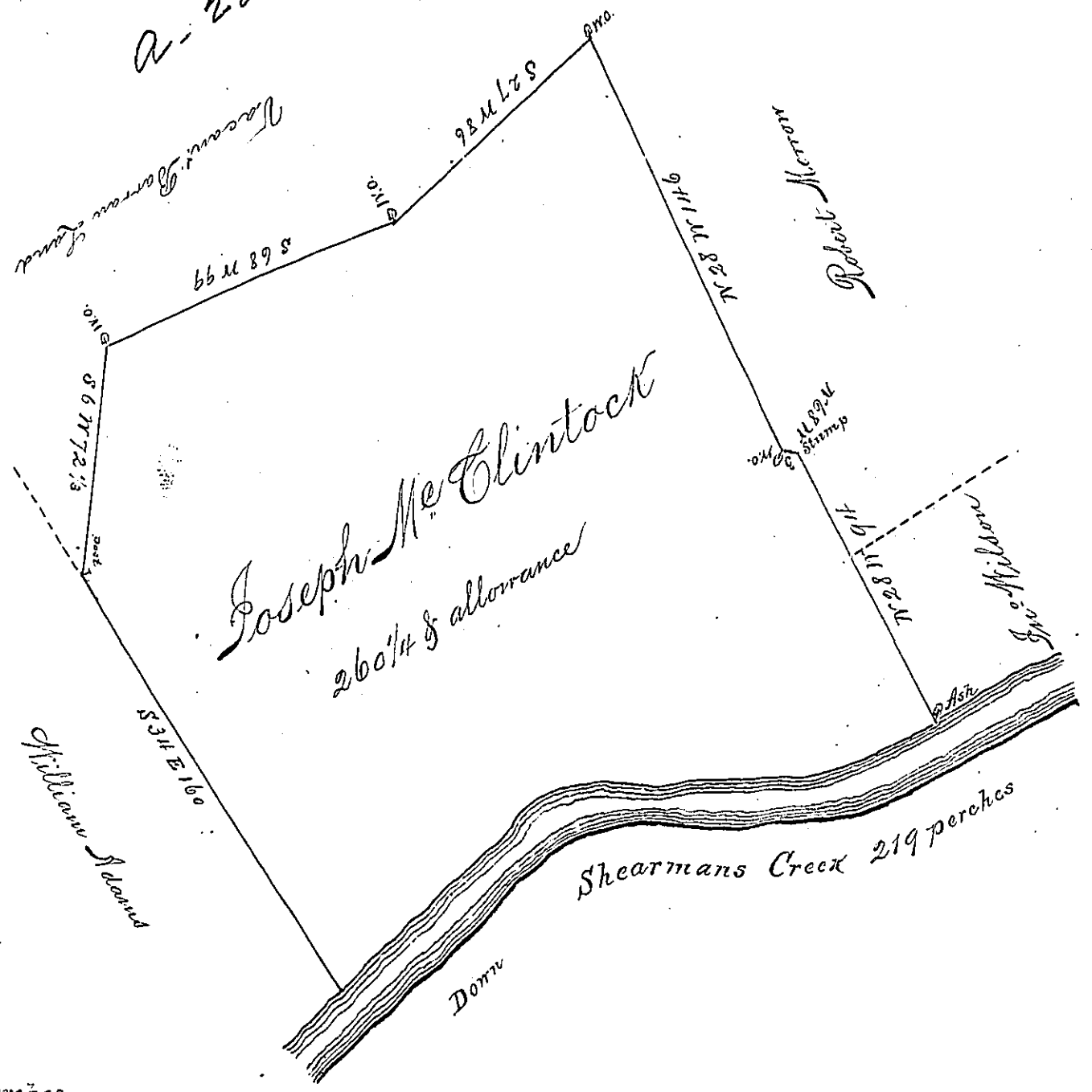

Courses and Distances Down Shearmans Creek
 N 55 E 26
 N 23 E 22
 N 49 E 144
 N 83 E 76
 N 71 E 51 219 perches

The Draught of a Tract of Land situate in Tyboine Township Cumberland County containing two hundred and sixty acres & one fourth of an acre & allowance Surveyed the 29th Day of August 1768 on an Order granted to Joseph M^cClintonck Dated the 6th of August 1768 N^o 788 for 250 Acres

I certify that the above is a Copy of a Survey Remaining in the Deputy Surveyors Office August 25th 1809
 Wm Wheeler D.S.

To Andrew Porter Esquire
 S. Y.

IN TESTIMONY that the above is a copy of the original remaining on file in the Department of Internal Affairs of Pennsylvania, made conformably to an Act of Assembly approved the 16th day of February, 1833. I have hereunto set my Hand and caused the Seal of said Department to be affixed at Harrisburg, this

first day of August 1895.

James W. Latta
 Secretary of Internal Affairs.